

-----	Bracket Assy. (See item 1)		Kit No.	700319
711105	Bracket Bolt Pkg. (Inc. items 5-7, 9)		Make	Hummer
None	Pulley Bolt Pkg.		Engine	Chevy 6.5L
None	Idler Bolt Pkg.		Fuel	Diesel
None	Fan Spacer Bolt Pkg.		Year	1997
			Equipment	Turbo
			Revised	NC 5-12-98

ITEM	PART #	DESCRIPTION
1.	711101	Pump mount bracket
2.	740242	Idler pulley/2.50" O.D., .668" I.D.
3.	*	Pump
4.	740144	Clutch/6-groove, 6.00" serp.
5.	110113	M10 x 90 x 1.5 Bolt
6.	110479	M10 x 30 x 1.5 Bolt
7.	110217	M10 x 70 x 1.5 Bolt
8.	110213	M10 Torx head shoulder bolt
9.	-----	-----
10.	110425	3/8NC x 1 1/4 Bolt
11.	110672	3/8 Lock washer
12.	110676	3/8 Flat washer
13.	-----	-----
14.	740206	Belt/Micro-V K061140

* See master list for pump part no.

FIG. 1

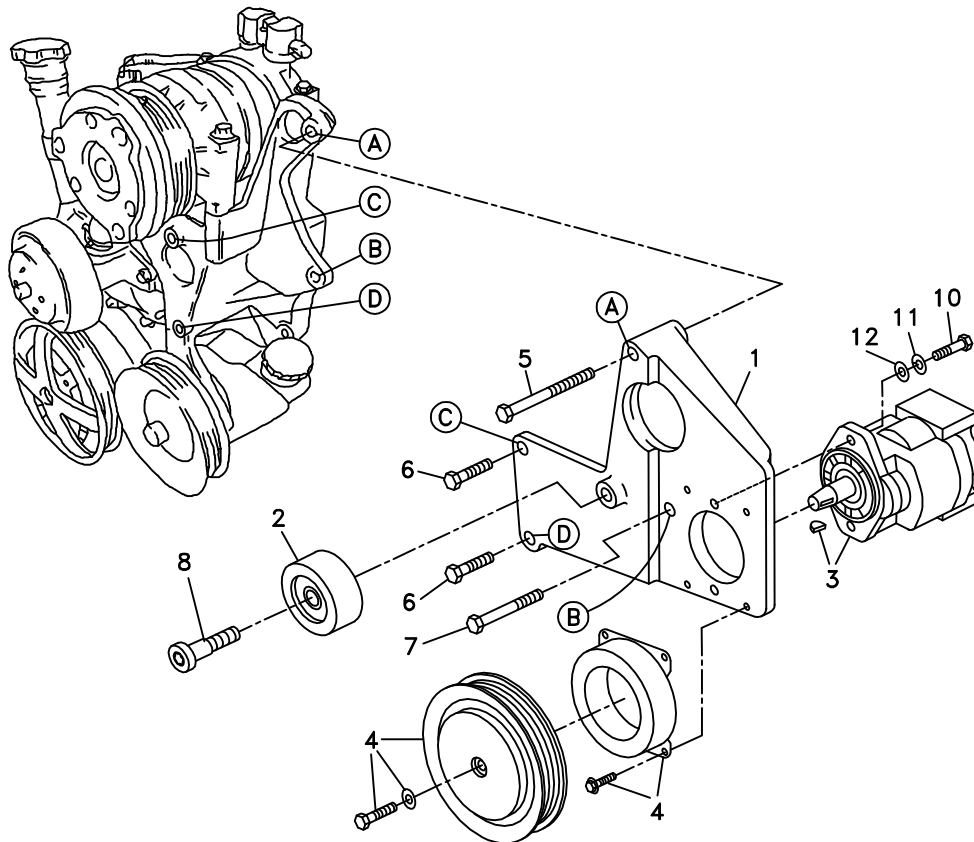

(A)(B)(C)... Denotes bolt holes in engine to locate corresponding holes in Pump Brkt.

FIG. 2

BELT DIAGRAM

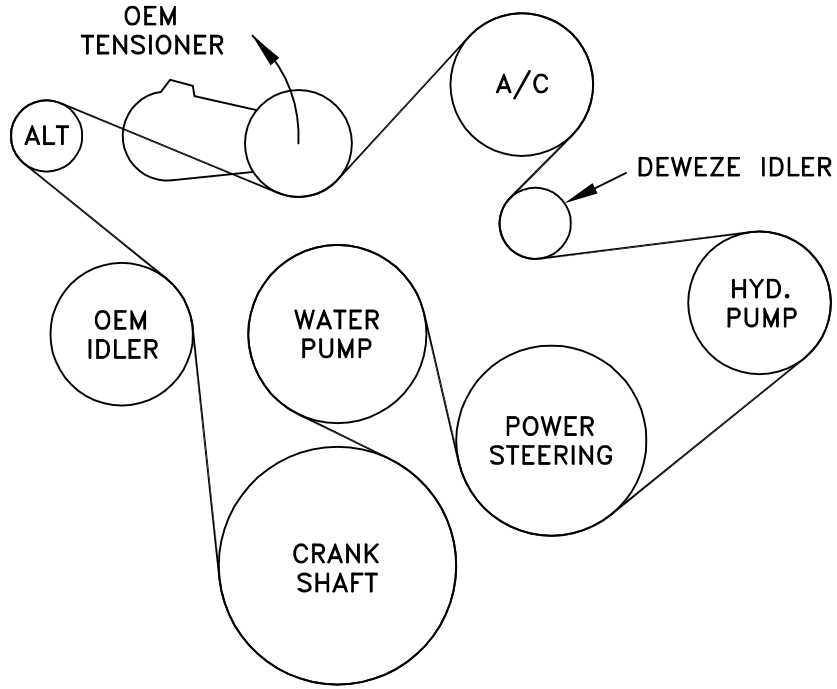

DewEze

Clutch Pump Kit
#700319
Hummer with
Chevy 6.5L
1997-98

I N S T A L L A T I O N I N S T R U C T I O N S

NOTE: Suction hose to pump must be a wire braid hose; minimum 1" I.D. for 7 & 9 GPM pumps, 1 1/4" I.D. for 12 & 17 GPM pumps. Installations with smaller suction hoses will void the pump warranty.

1. Disconnect battery.
2. Drain radiator so coolant level is below top radiator hose. Remove top hose from radiator.
3. Insert radiator hose through top hole in pump bracket (1). Mount bracket to air conditioner/power steering bracket using a 10 x 90 metric bolt at Location A, and 10 x 30 metric bolts at Locations C and D.
4. Mount idler pulley to mounting boss on pump bracket with 10mm Torx head shoulder bolt (8).
5. Attach pump (3) to back of pump plate using two 3/8 x 1 1/4 bolts (10), 3/8 lock washers (11), and 3/8 flat washers (12).
6. Bolt clutch coil (4) onto front of bracket using flange bolts supplied with clutch. Bolt clutch pulley onto pump shaft using bolt and washer provided with clutch.
7. Put on the belt (14) as shown in Fig. 2.
8. Replace coolant in the radiator.
9. Connect battery.
10. Run the engine and check for any clearance or alignment problems. Adjust as needed.